

CONFIDENTIAL				
THIS DRAWING AND THE DESIGN REPRESENTED HERON IS THE PROPERTY OF NILFISK-ADVANCE INC.. PLYMOUTH, MINNESOTA AND IT HAS BEEN ISSUED WITH THE UNDERSTANDING THAT IT WILL NOT BE REPRODUCED NOR COPIED NOR USED FOR ANY PURPOSE OTHER THAN FOR WHICH IT WAS ISSUED AND RECIPIENT AGREES TO RETURN IT UPON REQUEST.				
DWG NO	56380591	SHEET	1	REVISIONS
REV	ECO	DATE	DFTM	APPD
B	A-05873	7/28/10	GLF	DSM
	DEL: (1) 180-006, (1) 300-S-S, (2) 8, (2) 325, (2) 1345, NOTE 3. ADD: (1) 56381218, (2) 81104A, (2) 81109A, (2) 56009060, (1) S46A, (1) 700B, (1) 3060A			
C	A-06865	5-31-11	DJZ	DJZ
D	DEL: (1) 700B ADD: (1) 56381975			
	A-07230	9-12-11	MJP	DSM
E	DEL: (2) 2159, ADD: (2) 56002801 DESC: CARPET SCRUB S/S WAND 16 HEAD WAS WAND-SCRUB-16HEAD-2 TUBE			
	A-09497	6-11-13	ARM	SAB
	ADD: (1) 56381634, (2) 56383466, NOTE 3 DEL: (1) 2401, SHEET 2 QTY: 1156 (4) WAS (2), 81109A (4) WAS (2) DESC: CARPET SCRUB TI WAND 16 HEAD WAS CARPET SCRUB S/S WAND 16 HEAD			

DETAIL VIEW OF VALVE ASSEMBLY
SCALE 0.500

28	1		3060A	LABEL EVOLUTION 7.5 X 2.4
27	1		56381975	CARTON ASSEMBLY
26	1		S46A	CAP BLACK VINYL 2 ID X 1 LO
25	1		MA-14	MANIFOLD VACUUM FOR CSW-16 ROT
24	1		85-S-S	VALVE-2500 PSI-W/LEVER
23	4		81109A	NUT, 8-32 ESNA S.S.
22	2		81104A	NUT, 1/4" NYLOCK
21	1		729A	HANDLE-2 INCH-EVO WAND
20	1		45-S-S	QD-PLUG-SS-MALE-VITON SEALS
19	2		398A	WASHER 1/4 AN S/S FLAT .515
18	1		2099TMR	BRACKET-EV WAND-TMR
17	1		2099TML	BRACKET-EV WAND-TML
16	1		2098A-S-S	SPRAYBAR S/S FOR TRUCKMOUNT
15	1		2097B	GLIDE-SLOTTED-DELTRIN-CSW 16
14	1		1153B	SLEEVE-6 LONG X 2 DIA-BLACK
13	1		1100D	HOSE-PRESSURE-SW IVEL-1/4 X 51
12	4		076-037	SPRAY TIP SS
11	1		56383466	BRACKET-VALVE HANGER-BOLT ON
10	1		56381634	TUBE-TITANIUM-GRADE 2
9	1		56381218	FITTING HYD
8	2		56380681	SPRAY TIP-SS-95 DEG-1.5 OPEN
7	2		56009060	WSH-FLT SS .260 X 1.000 X .074
6	2		56002801	SCR- HEX SS 1/4-20 X .50
5	2		2147	BOLT-HEX HD-CAP-SS-5/16X3/4 18-8
4	1		1591	SCREW -SET-10-24-SS-3/8-SLOT
3	2		1586	STRAP-HOSE-VELCRO-8.5 X 1.5
2	4		1156	SCREW 8-32 X 1-1/8 LONG P
1	4		218	WASHER RUBBER 1/4 ID X 3/4
ITEM	QTY	U/M	PART NUMBER	DESCRIPTION

BILL OF MATERIAL

MATERIAL: NONE
FINISH/COLOR: NONE

NOTES UNLESS OTHERWISE SPECIFIED
1.ALL DIMENSIONS IN INCHES.
2.DO NOT SCALE DRAWING.
3.ALL DIMENSIONS APPLY AFTER PLATING AND HEAT TREATING, BUT BEFORE PAINTING.
4.REMOVE ALL BURRS AND SHARP EDGES.

DRAWN 30-Jan-13 TMG
CHECKED
PRJ ENG
APPD
APPD
APPD

Nilfisk Advance
CARPET SCRUB TI WAND 16 HEAD
NILFISK-ADVANCE, INC.
PLYMOUTH, MN 55447
SPRINGDALE, AR 72764

SIZE DWG NO 56380591
D
SCALE 0.250 ASSY
PRO-E DATA
FUD
SHEET 1 OF E

EXPLODED ASSEMBLY DRAWING RELATED DATA

THIS ASSEMBLY MAY CONTAIN GRAPHICAL REPRESENTATION (.GR) MODELS. THESE MODELS ARE FOR REPRESENTATION ONLY AND ARE NOT TO BE USED FOR MANUFACTURING.

15
C
QUANTITY REQUIRED BY CUSTOMER AND COMPANY STOCK ON HAND

DIM. IN I J ARE MM.
UNITS IN I J ARE ISO METRIC
AS NOTED.

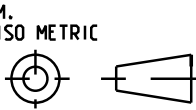

3. NOT SHOWN
INSTALL VINYL CAP (PRT# S46A) ON TO END OF HANDLE FOR SHIPPING.
T. USE FOAM FOR PACKING.

-NOTES-